

Bradentown - C.C.  
 Palma Sola COURSE 1 HOLE  
 410

DONALD J. ROSS, GOLF ARCHITECT.

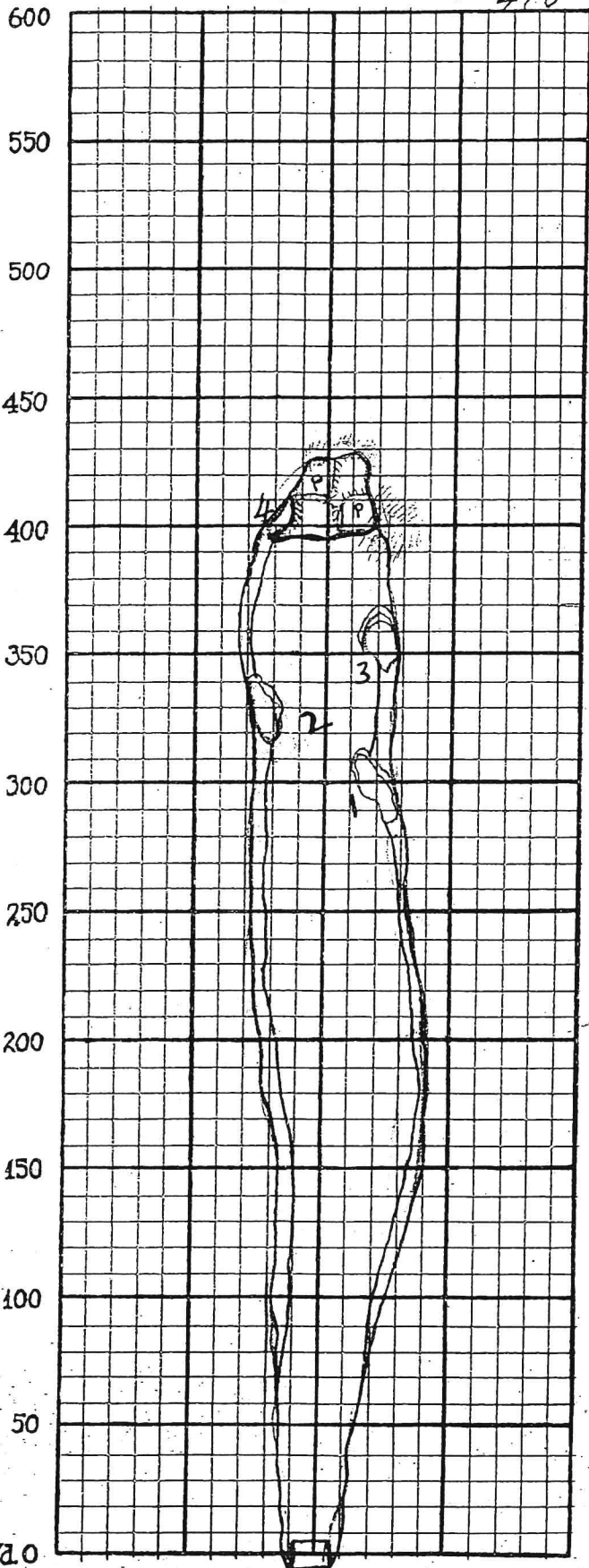

SECTIONS

6	
5	
4	
3	
2	
1	
4	
3	
2	
1	
0	
1	
2	
3	
1	
2	
3	

Top 50' x 30' - raised 6 inches  
 + planted with Bermuda grass  
 nos 1-2-3 - Bunkers  
 depress as far as drainage  
 will permit - the finished  
 face to be not less than  
 4' deep - faces planted  
 with bunches of wire grass  
 No 4. Bunker - raise  
 the face 2' on edge  
 of green - + finished face  
 to be 3'-6" deep



all the green to be  
 planted with Bermuda  
 grass

Body of green raised 1'-at  
 A + 3'-at B with  
 an irregular outline.

Platane No 1 to be  
 1'-above body of green

Platane No 2 to be  
 1'-6" above body of  
 green.

Plateaus should blend  
 into putting surface without  
 any sharp ridges.

M is a granular mound irregular  
 in outline & not less than 4' high  
 + 40' wide at the base - this mound

must blend into fair way or  
 putting green without any sharp  
 hollows or ridges.

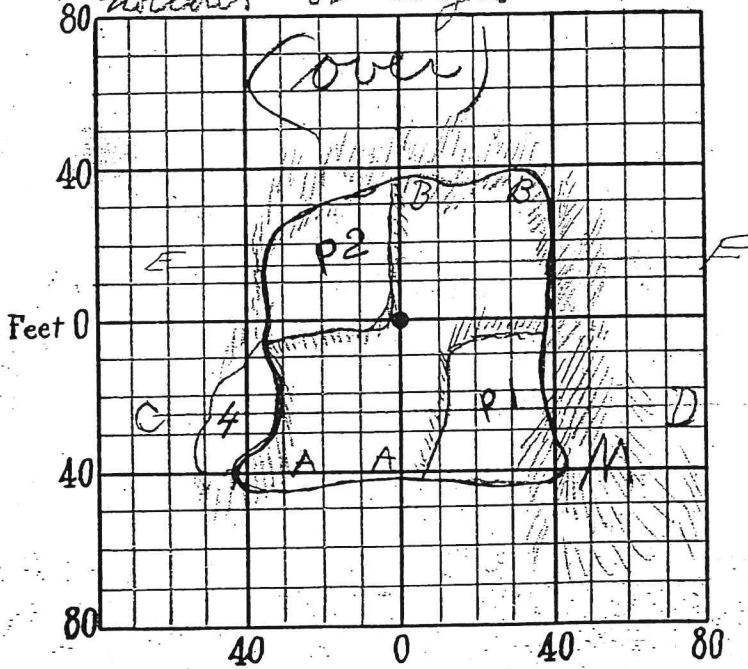

Make cross sections  
 for greens -

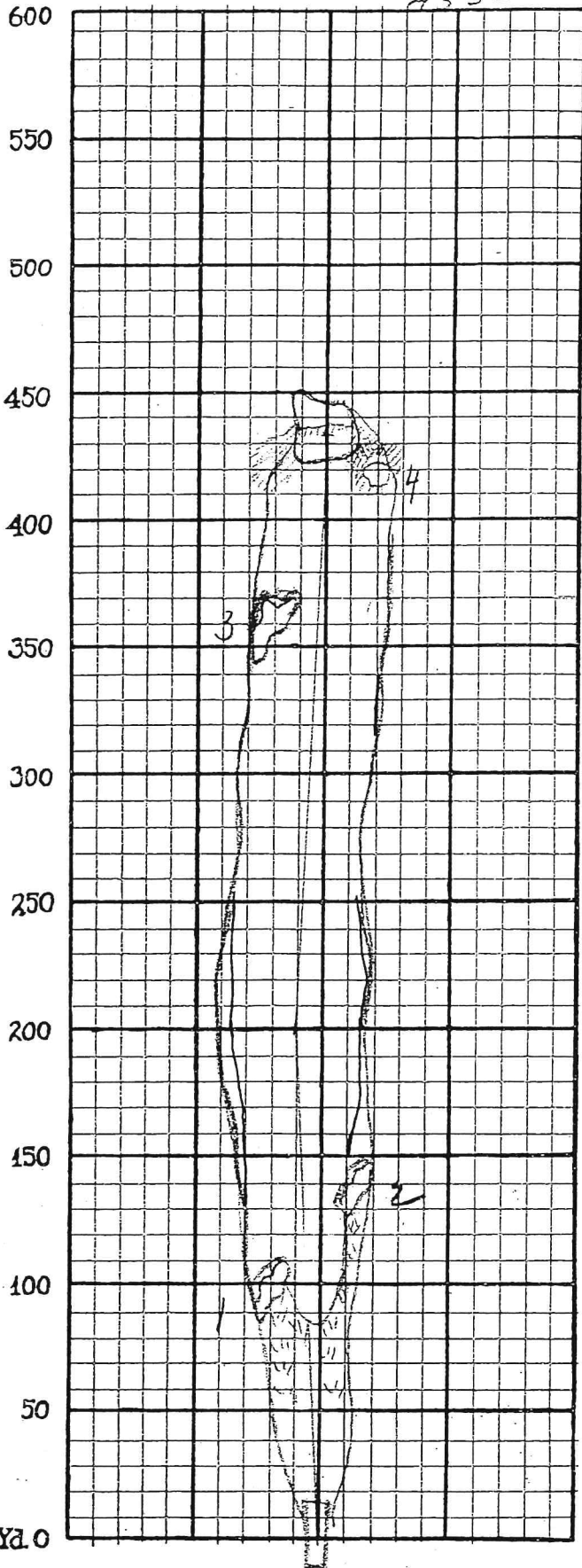

SECTIONS

- 6
- 5
- 4
- 3
- 2
- 1

---

- 4
- 3
- 2
- 1
- 0
- 1

---

- 2
- 3
- 2
- 1
- 0

---

- 1
- 2

---

- 2
- 3

Tee 80' x 20' raised  
6 inches & planted with  
Bermuda grass

no. 1-2-3 Bunches  
depress as far as  
drainage will permit  
but not over 2'-6"  
The finished face to  
be 4' deep - ~~the~~  
raised faces planted  
with wire grass  
bunches

Body of green raised  
 1" at A. rising  
 on a 2% grade toward  
 the rear half  
 on rear half  
 a plateau - 1-6" high  
 above the body of  
 green -  
 the outline on  
 the rear should  
 be irregular - forming  
 a bold back ground  
 (see section)

NOTES

..... COURSE  
 ..... HOLE ..... 433 YARDS  
 GREEN

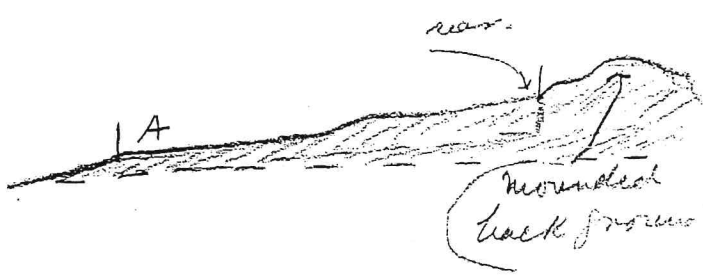
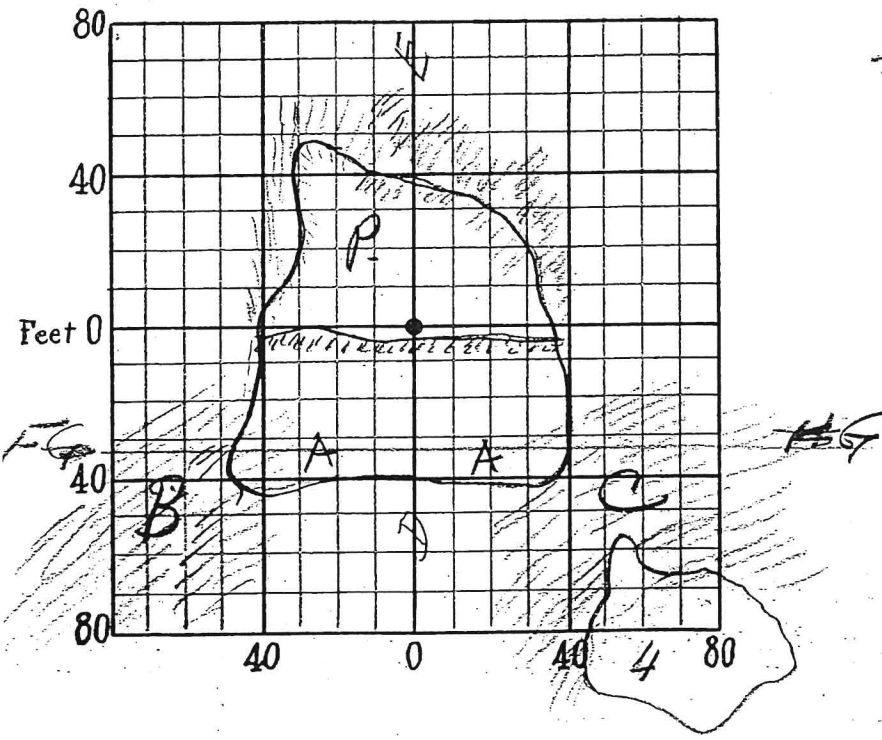

show cross section  
 B - a flat grass  
 mound 3' high  
 + 30' wide -  
 C - a grass mound  
 4' high - 40' wide  
 at the base - with  
 a por bunker in  
 the face of it -  
 Mounds must blend into putting  
 green & fairway without sharp grades -

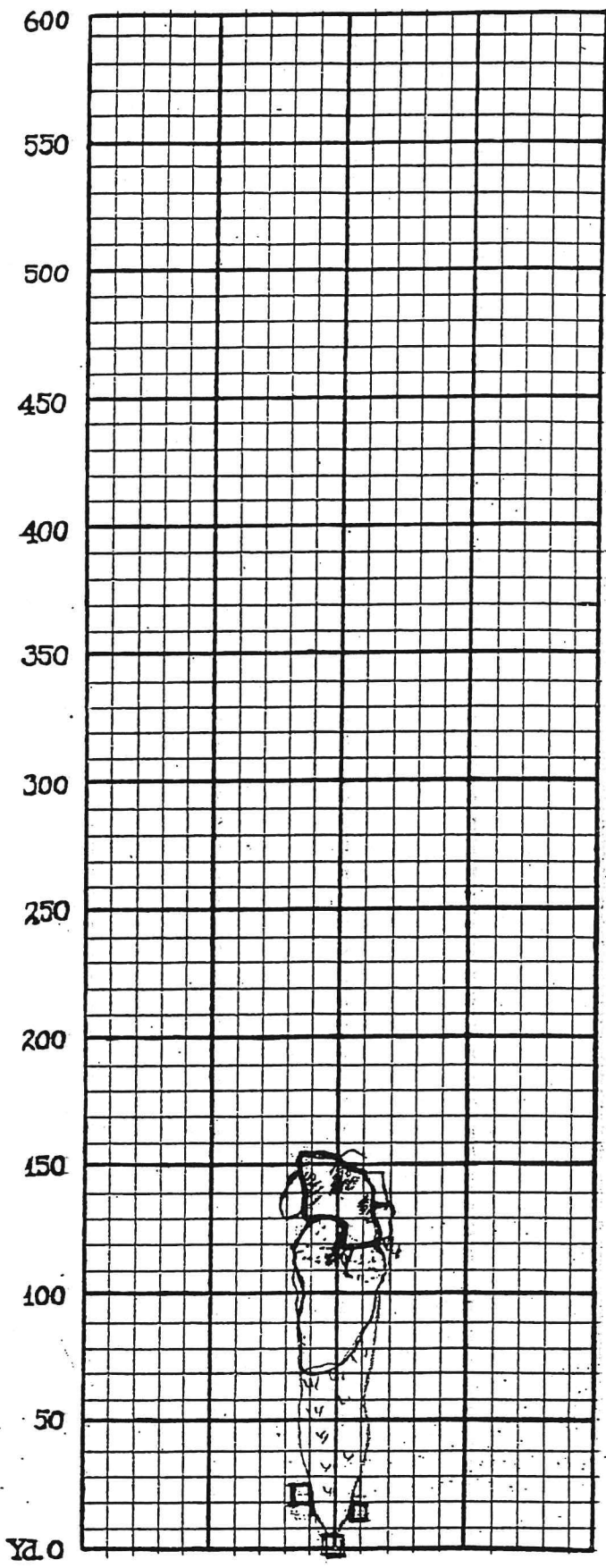

SECTIONS

6	-----
5	-----
4	-----
3	-----
2	-----
1	-----
-----	
4	-----
3	-----
2	-----
1	-----
0	-----
1	-----
2	-----
3	-----
2	-----
1	-----
0	-----
1	-----
2	-----
3	-----

3 tees - 20' x 12' + raised  
 6 inches + planted with  
 Bermuda grass -

(over 1/2 green)

Plataan green -

at A - free 2'-6"

at R " 5'

Bunkers 1 + 2 - to be 2' deep and wide giving appearance of 2 sand waste -

Bunkers 3 4 5 - to be 3'-6" deep -

note the undulations leading from faces of bunkers - 3-5-6 - giving an irregular outline to green -

NOTES

COURSE  
HOLE 140 YARDS

GREEN

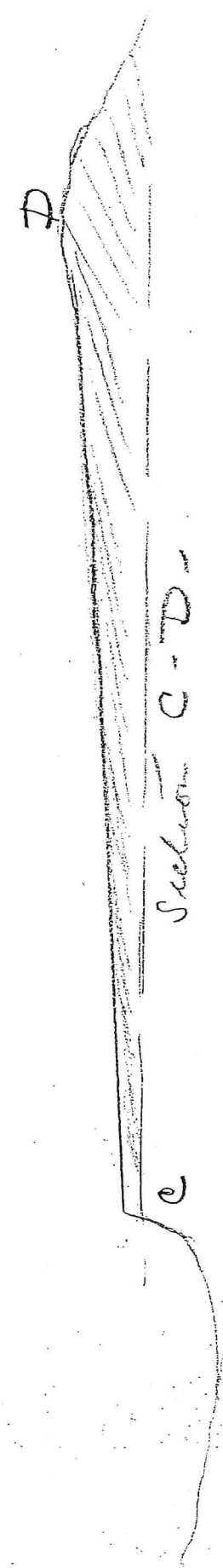
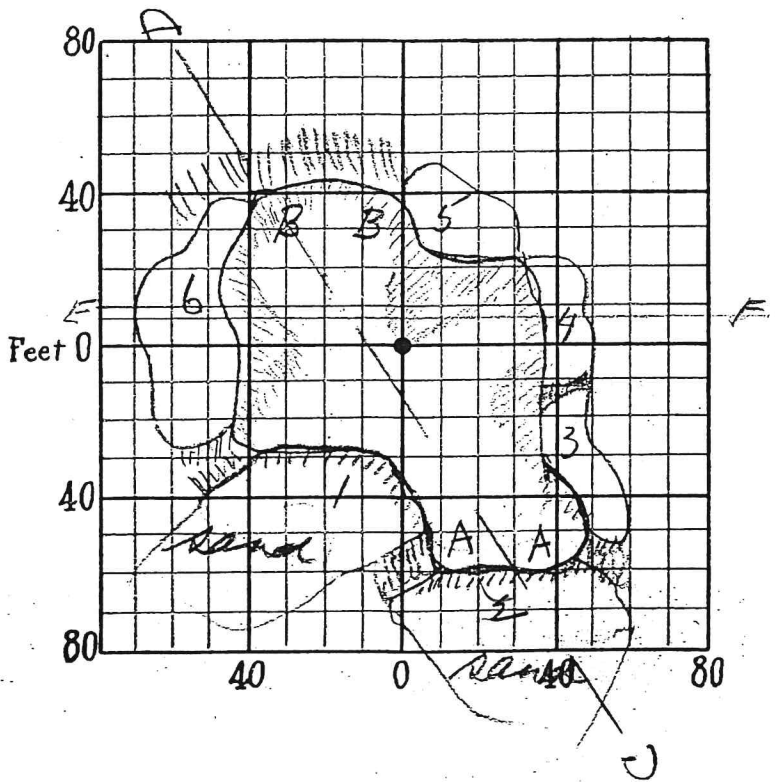

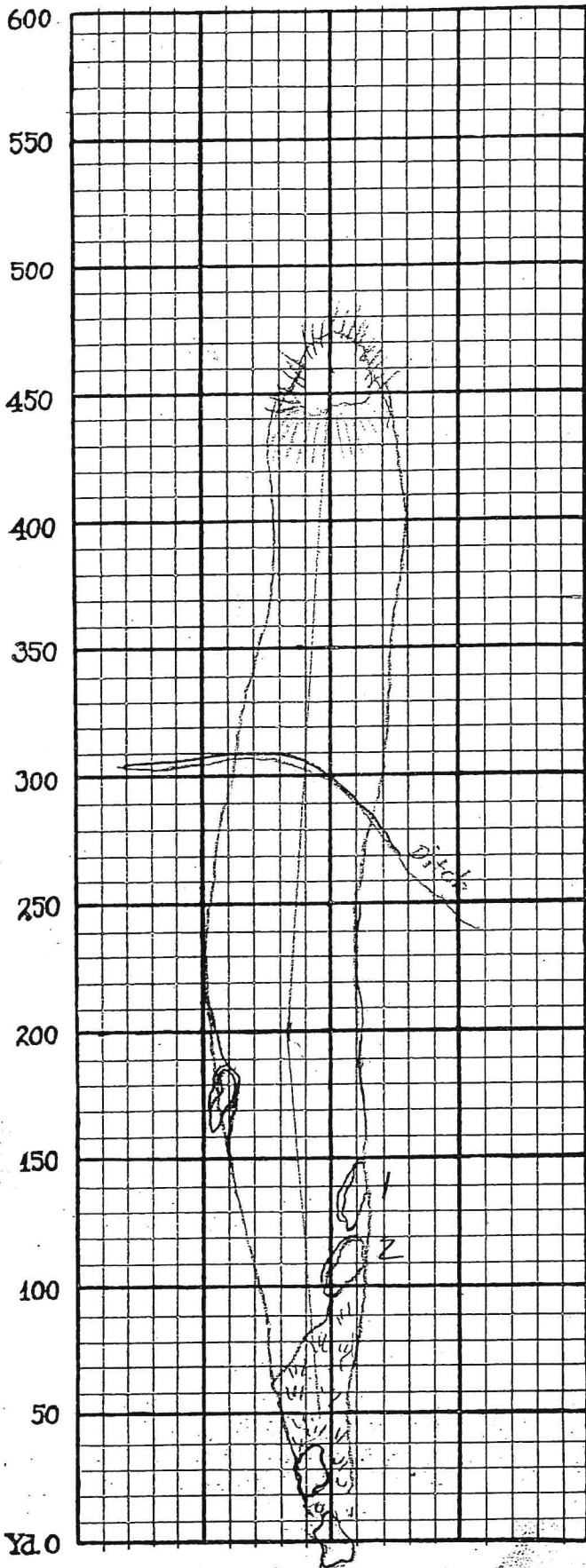

SECTIONS

6	
5	
4	
3	
2	
1	
<hr/>	
4	
3	
2	
1	
0	
1	
2	
3	
2	
1	
0	
1	
2	
3	

2 Tee 80' x 30' diagonal  
with line of play +  
irregular in outline -  
raised 6 inches -

No 1 + 2-3-Bunkers -  
depress 2' - if drainage  
will permit - finish  
the faces 4' 6" deep +  
plant them with tufts of  
wire grass -

Ditch across the course  
not less than 4' wide  
near side sloped to far  
side raised 2' - so



Green built up 3' leaving a flat top 60' wide - in the form of an inverted saucer - the sides to slope with a long easy grade to meet the fair way - the front approach to be flat

NOTES

COURSE

HOLE

460 YARDS

GREEN

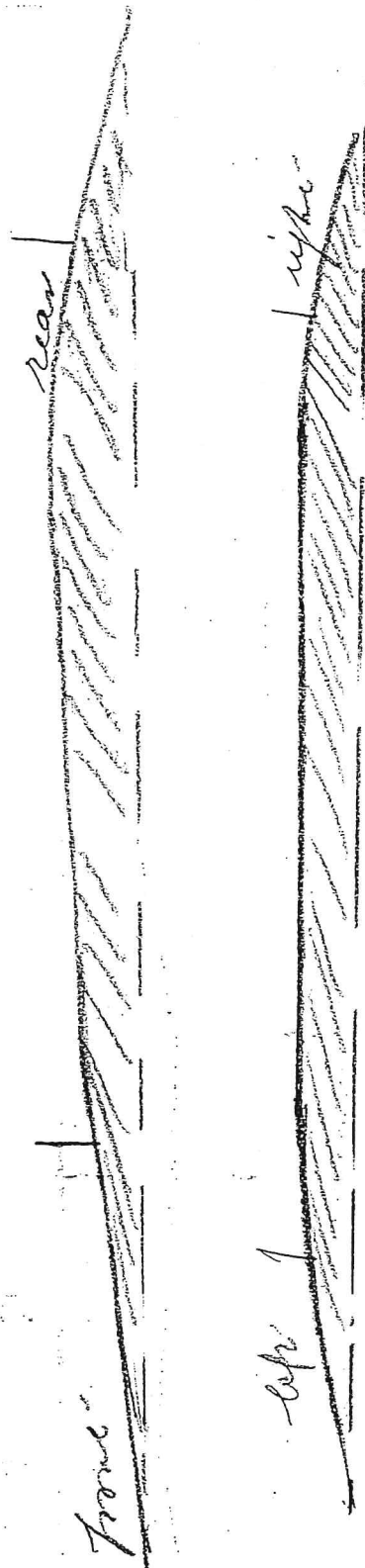
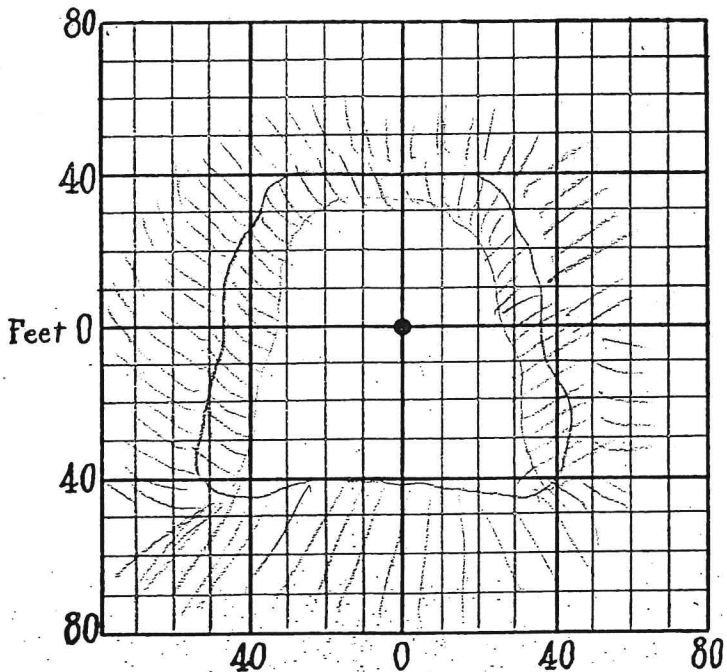



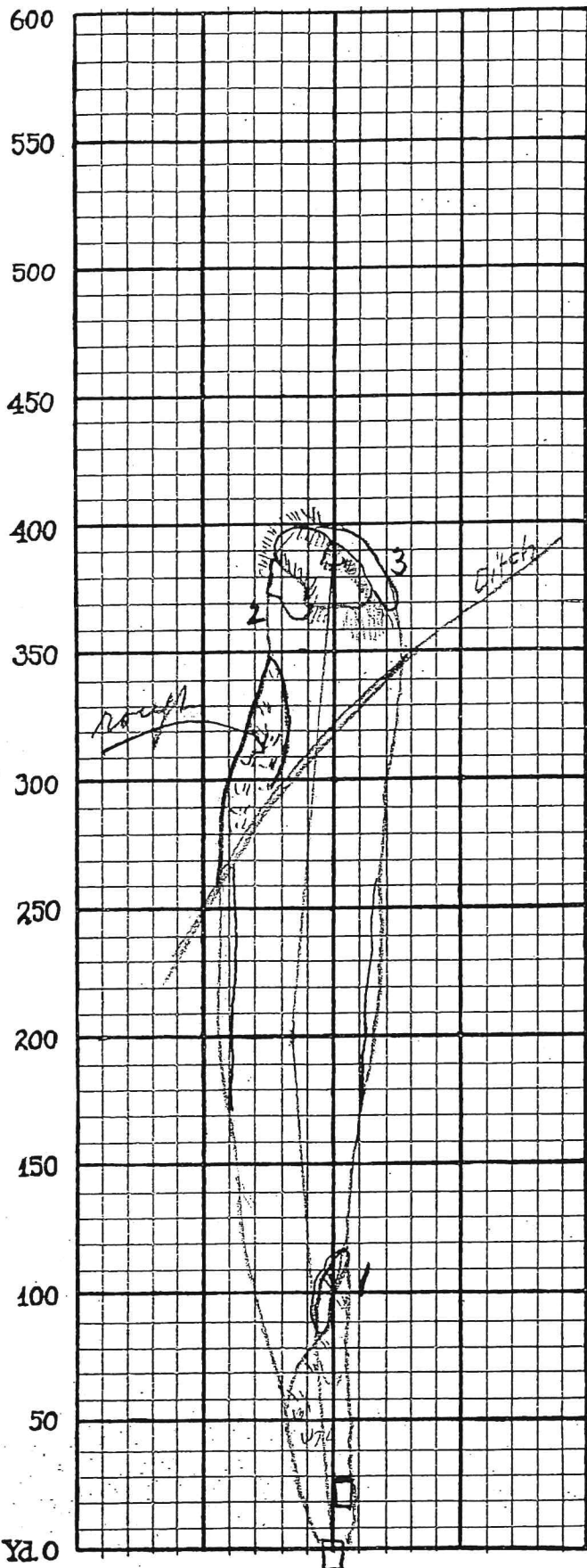

SECTIONS

6	
5	
4	
3	
2	
1	
4	
3	
2	
1	
0	
1	
2	
3	
2	
1	
0	
1	
2	
3	

2 tees 35' + 20' - raised  
 6 inches - + planted  
 with Bermuda grass

no 1 - Bunker - depress  
 2' if drainage well  
 present - finish the face  
 4' - 6" deep - + plant with  
 wire grass -

Treat the ditch as specified  
 on no 4 hole -

at A. Fills 2'-  
 at B. Fills 4'-6"  
 giving the green a  
 slight lean to the left

Bunker 2 to be 3'-6" deep  
 Bunker 3 to be 4' deep

NOTES

..... COURSE  
 ..... HOLE ..... 385 YARDS

GREEN

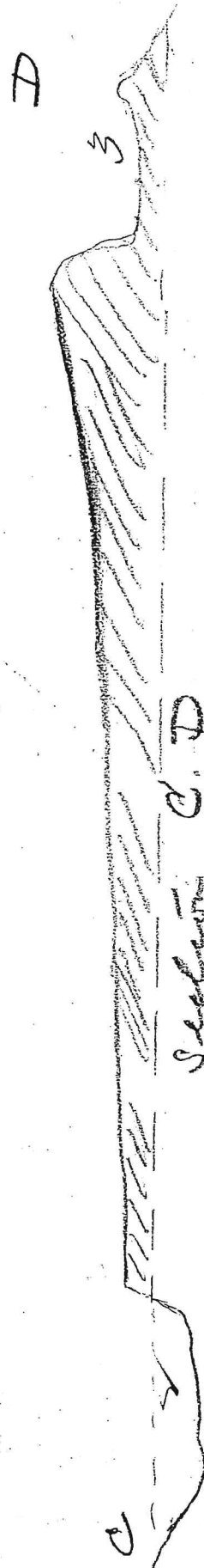
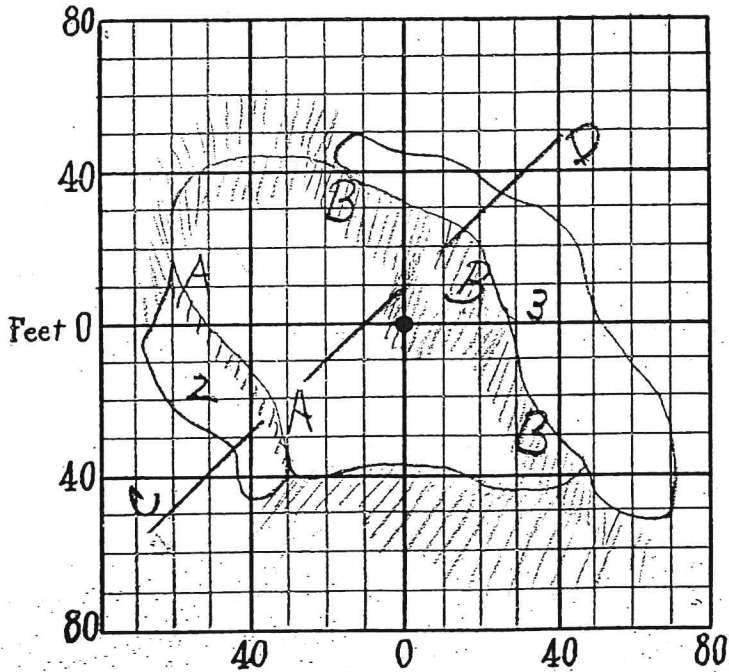

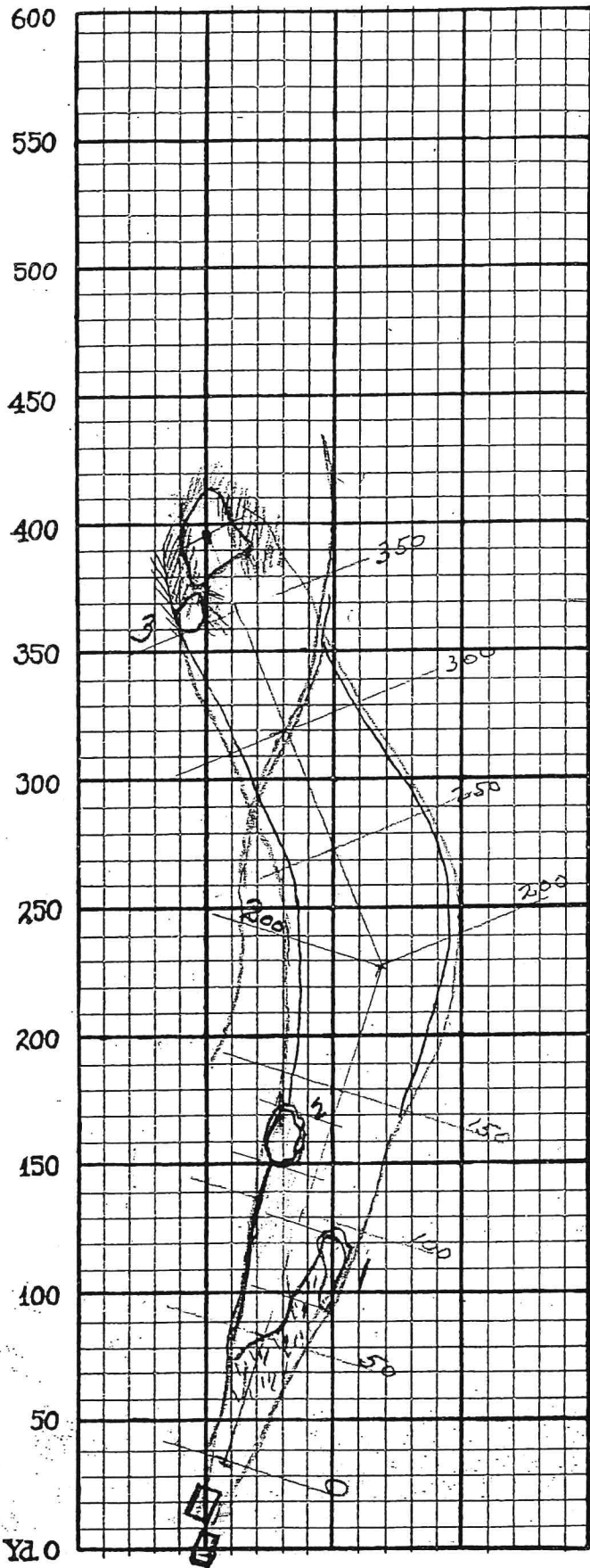

SECTIONS

6	
5	
4	
3	
2	
1	
<hr/>	
4	
3	
2	
1	
0	
1	
2	
3	
2	
1	
0	
1	
2	
3	

2 is 5'0" x 20' - raised 6 in  
+ planted with Bermuda grass

no 1-2 - Bunkers - depress  
2' if drainage will permit  
finished face to be 4' deep  
+ planted with wire grass.  
Treat the detail in the  
same manner as specified  
on no 4 hole

no 3 - Bunker in fall  
of M-1.

Green built in form  
of a slight valley

at A. Raise 1'  
at B " 3'-6"

M1 - is a fair grass  
mound not less than 5'  
high -

M2 - is a fair grass  
mound not less than  
6' high - both mounds  
blending into green &  
fair way - with easy  
grades

NOTES

COURSE

HOLE

396 YARDS

GREEN

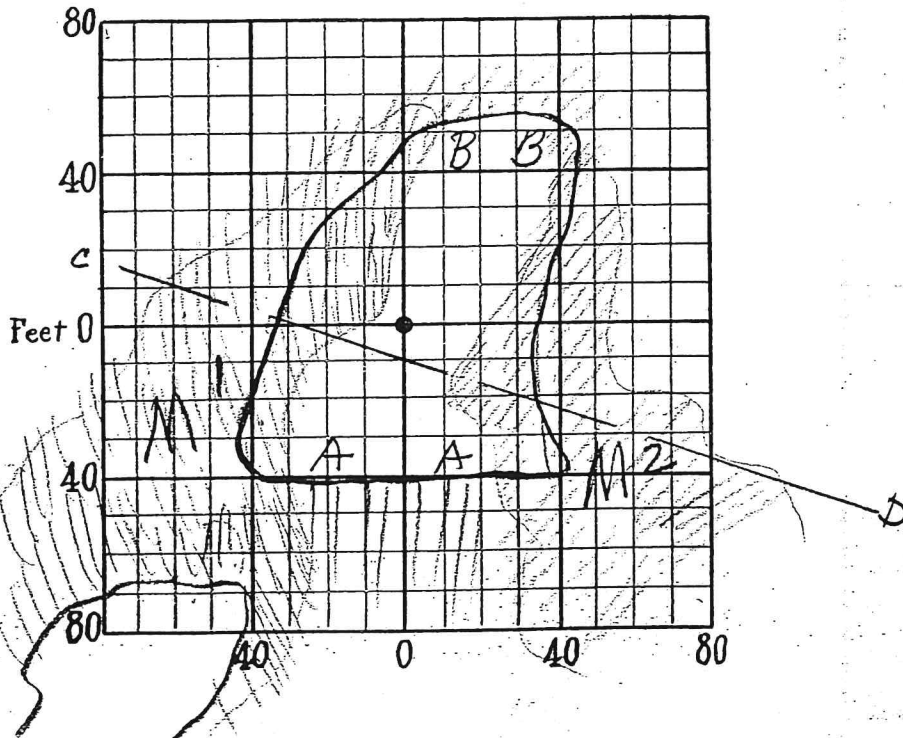

Section C-D

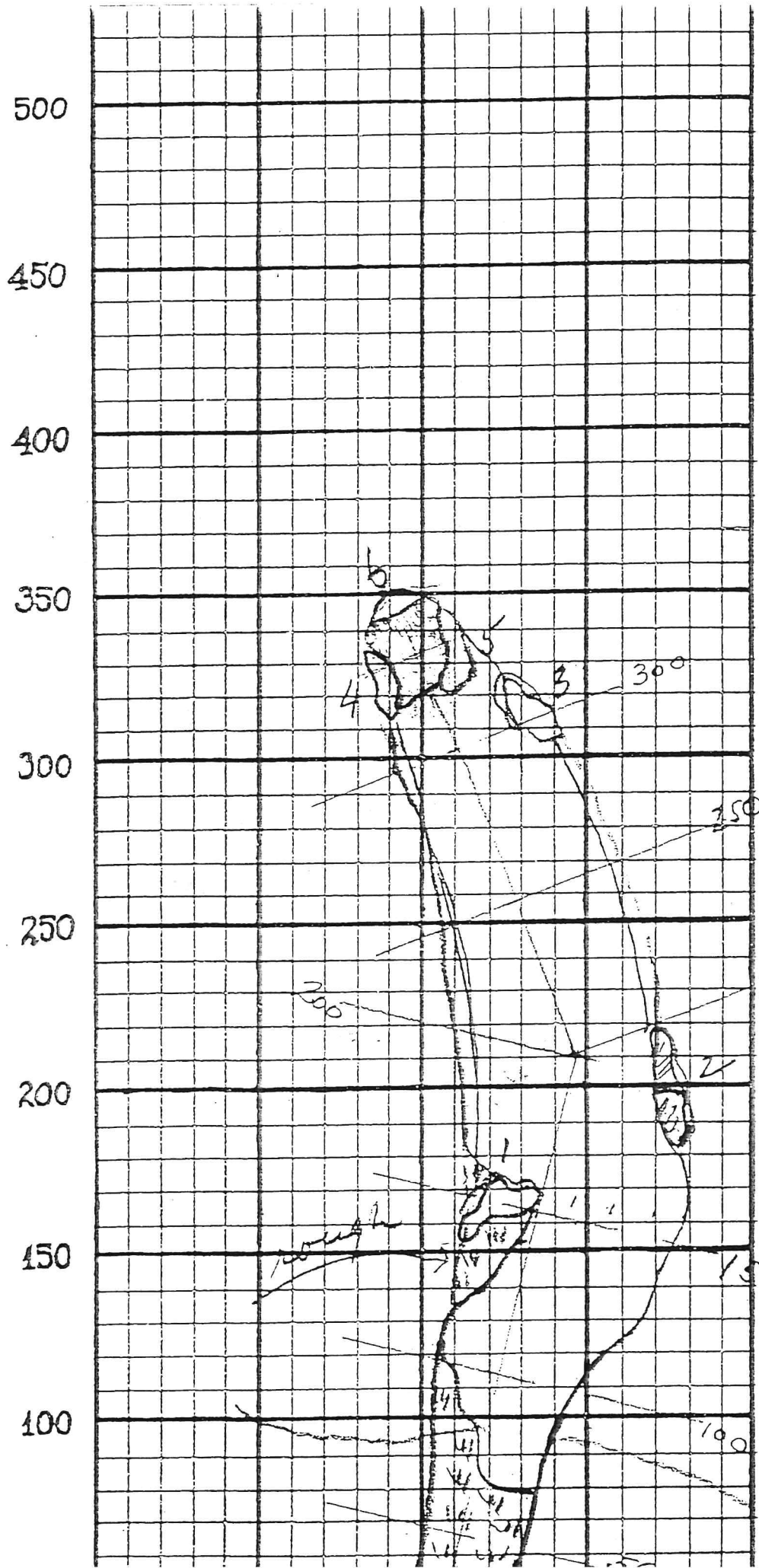

7
4
3
2
1
0
1
2
3
2
1
0
1
2
3

*Tree &  
6 inches  
Perman*

*no 1 -  
if drawn  
fines  
deep -  
trifling*

*no 2 -  
mounds  
& plants  
wire for*

*no 3 -  
2' if the  
first*

note how opening to green  
is wider on the left of  
centre than it is on right  
of centre -

Green raised 1' at  
A -  
at B raised 3'-6"  
with an irregular  
outlining on rear -  
Faces of bunkers  
4-5 raised 2' forming  
a slight valley effect  
on entrance to green

NOTES

..... COURSE  
..... HOLE 333 YARDS  
GREEN

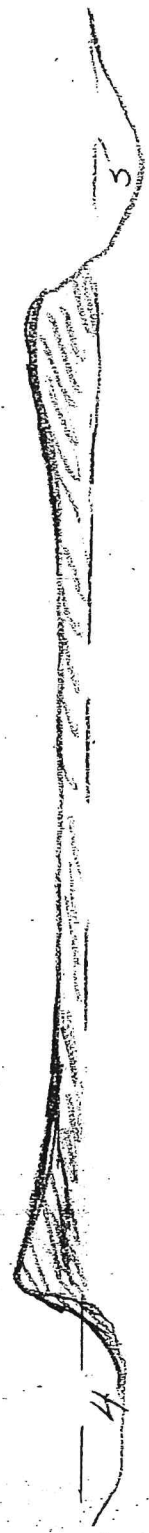
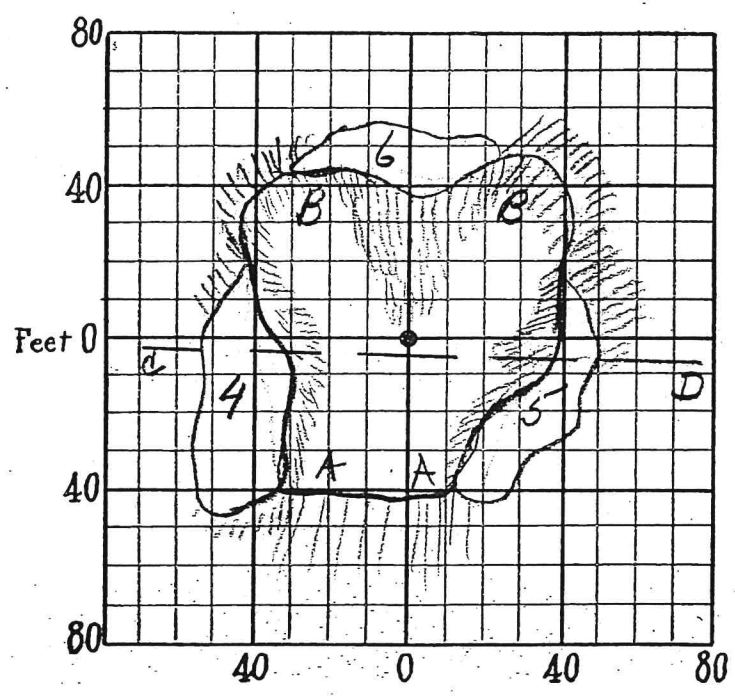

Section C.D.

//  
//

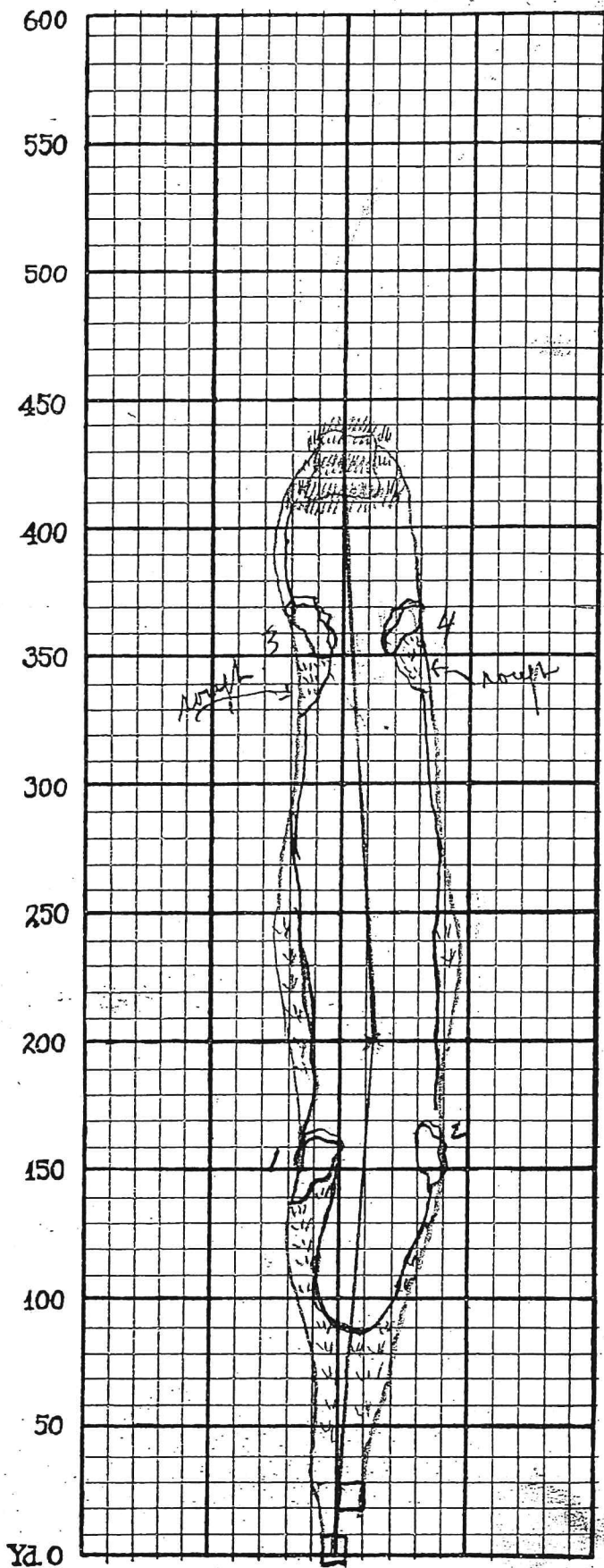

SECTIONS

6
5
4
3
2
1
4
3
2
1
0
1
2
3
2
1
0
1
2
3

2 fcs 30' Square - raised  
6" & planted with Bermuda  
grass.

1 & 2 Bunker depress.  
2' if drainage will permit  
finished face 4' deep  
Plant face with wire grass  
no 3 & 4 Bunker  
depress 2' if drainage  
will permit. finished  
face to be 4'-6" deep  
& planted with wire  
grass -

Body of green raised  
6 inches

A - an undulation  
1' high 20' wide at  
base

B - a flat plateau  
1'-6" above body of green

C - an irregular shaped  
undulation 3' above level  
of green & 30' to 40' wide

NOTES

HOLE

COURSE

425

YARDS

GREEN

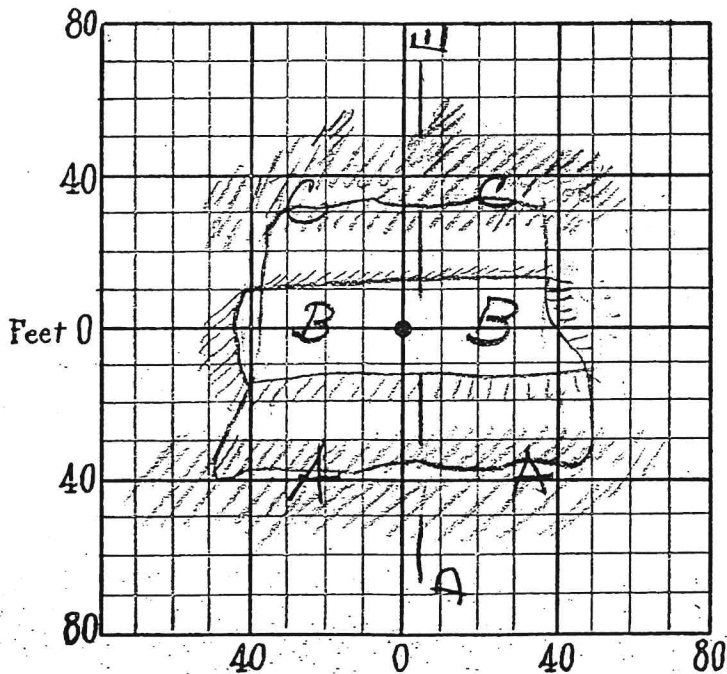

E



Section D E

D



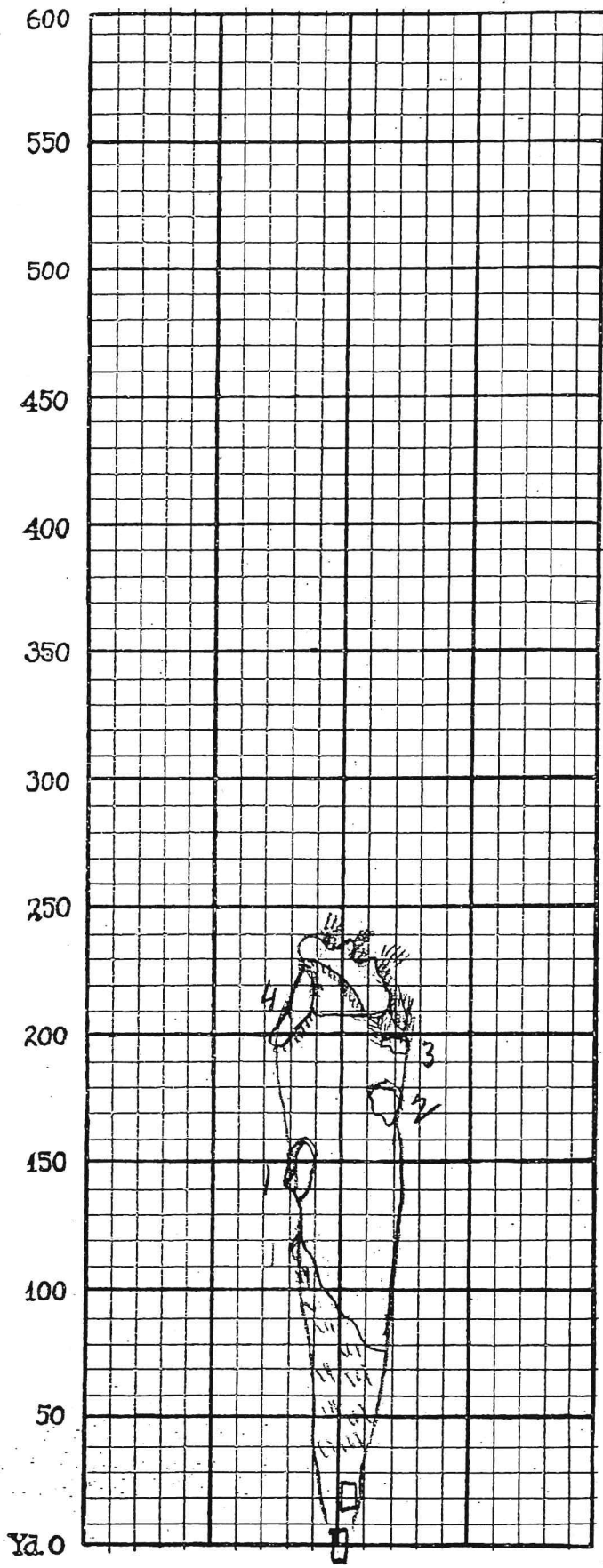

SECTIONS

6	.....
5	.....
4	.....
3	.....
2	.....
1	.....
-----	
4	.....
3	.....
2	.....
1	.....
0	.....
1	.....
2	.....
3	.....
2	.....
1	.....
0	.....
1	.....
2	.....
3	.....

2 cuts 5'0" + 15'

no's 1 & 2 - Bunkers depress  
2' if drainage were formed  
the finished face to be  
4' 6" deep & planted with  
wire grass

no 3 - Bunker - with  
a mounded face 4' high  
& planted with Bermuda  
grass

no 4 - Bunker - depress  
7' 6" raise the face 2' 6"  
with a long grass into  
green & fair way - finished  
face is 4' deep -

Body of green as  
A raised 6 inches

Plateau around the  
rear - 1' 6" above  
body of green - <sup>on the rear.</sup>

3 flat undulations (M) not  
less than 4 high +

20' wide - these  
undulations should blend  
into the plateau forming  
one rolling surface -

NOTES

COURSE

HOLE

221 YARDS

GREEN

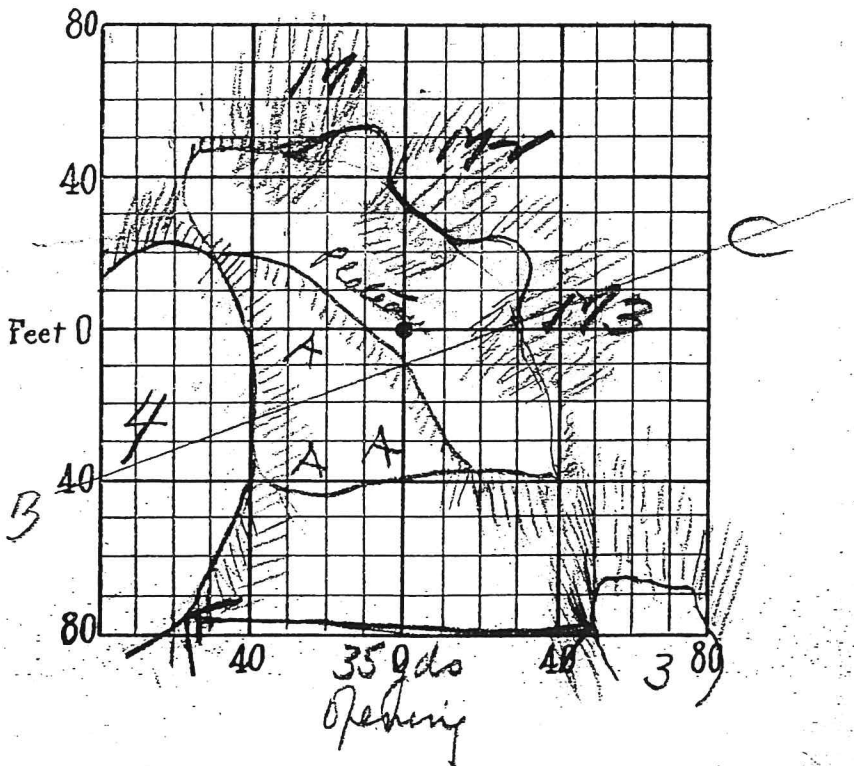

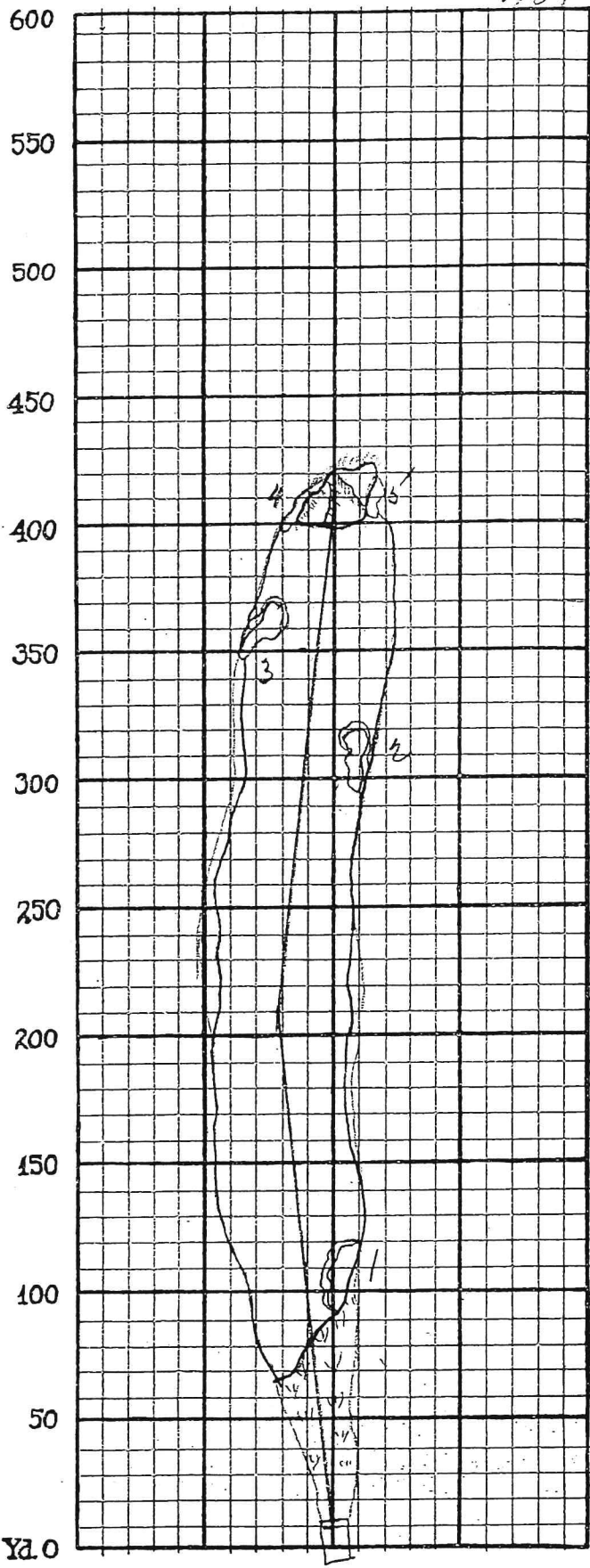

SECTIONS

6	
5	
4	
3	
2	
1	
<hr/>	
4	
3	
2	
1	
0	
1	
2	
3	
2	
1	
0	
1	
2	
3	

tee 50' x 30' raised 6"  
& planted with Bermuda

no 1-2-3 - Bunkers -  
depress 2" of drainage  
will permit the bunker  
face to be 4" deep -

Body of green raised  
 1' at A gradually  
 rising with a fall of  
 3' at least on the rear  
 at B.

P. 1 - is a plateau 1' above the level of the body of green

P. 2 - is a plateau 1' 6" above the level of the body of green.

Back ground at C should be bold-forming a clear view of the green from the tee -

NOTES

no 4. 5 - Bunkers COURSE

HOLE with a face finished YARDS

GREEN

4' deep -

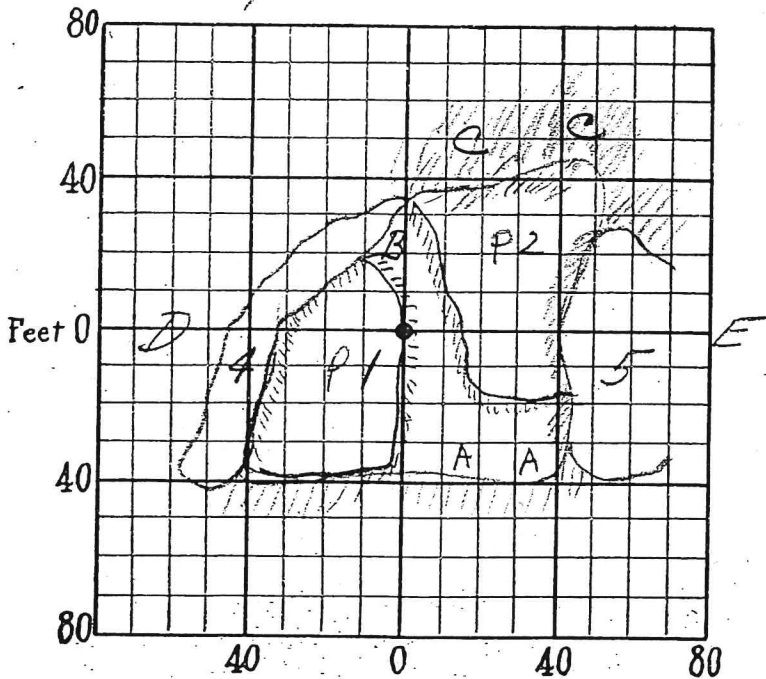

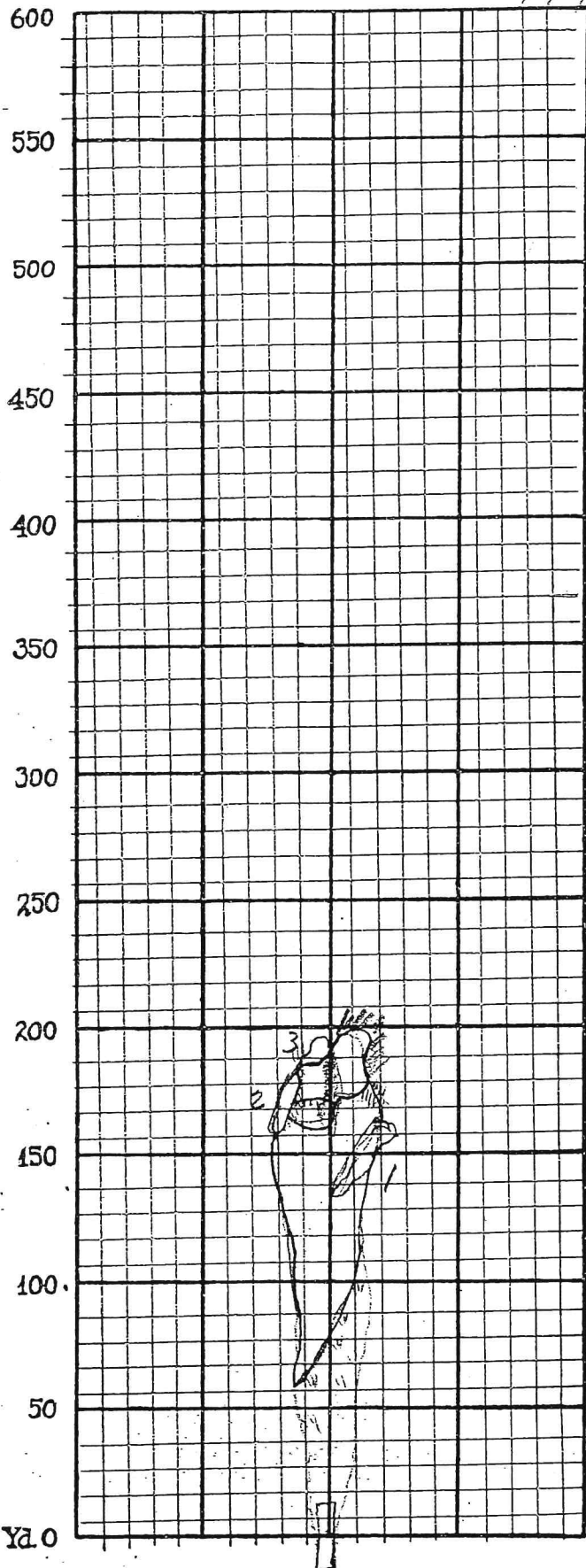

SECTIONS

6	
5	
4	
3	
2	
1	
<hr/>	
4	
3	
2	
1	
0	
1	
2	
3	
2	
1	
0	
1	
2	
3	

Tee 80' x 20' raised  
6 inches - + planted  
with Bermuda grass

Bunker No 1 - depth  
2'-6" if drainage will  
permit the face should  
be finished 4' deep -  
the face must have  
openings so that all the  
green can be clearly  
viewed from the tee.

Section A. raised  
2' above present  
level.

Section B - raised  
4' above present  
level.

C - an undulation  
1/2" above the level  
of B. forming an  
division between  
the higher level B  
& lower level A + E

D - grass mound -  
irregular in shape  
& not less than  
4' high -

NOTES

..... COURSE  
..... HOLE ..... YARDS

Section E. GREEN  
built 1- above present level.

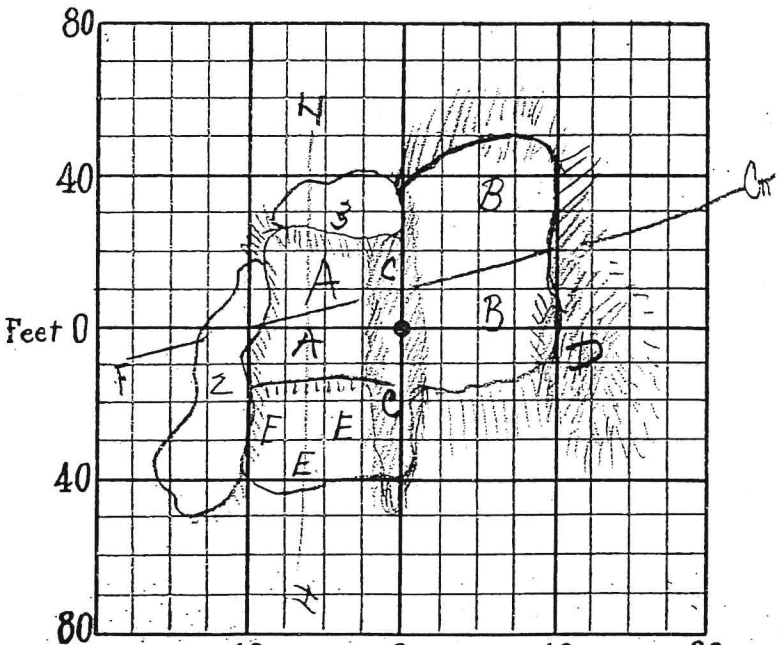

Bunker no 2 finished 4' deep  
" no 3 " 3' deep

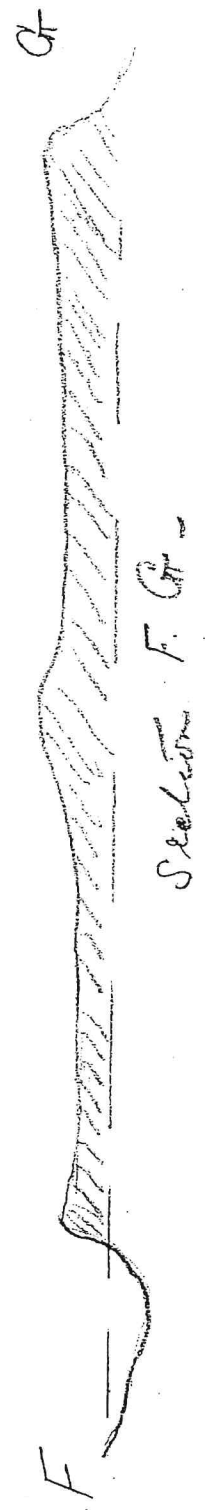

COURSE 17 HOLE  
350

DONALD J. ROSS, GOLF ARCHITECT.

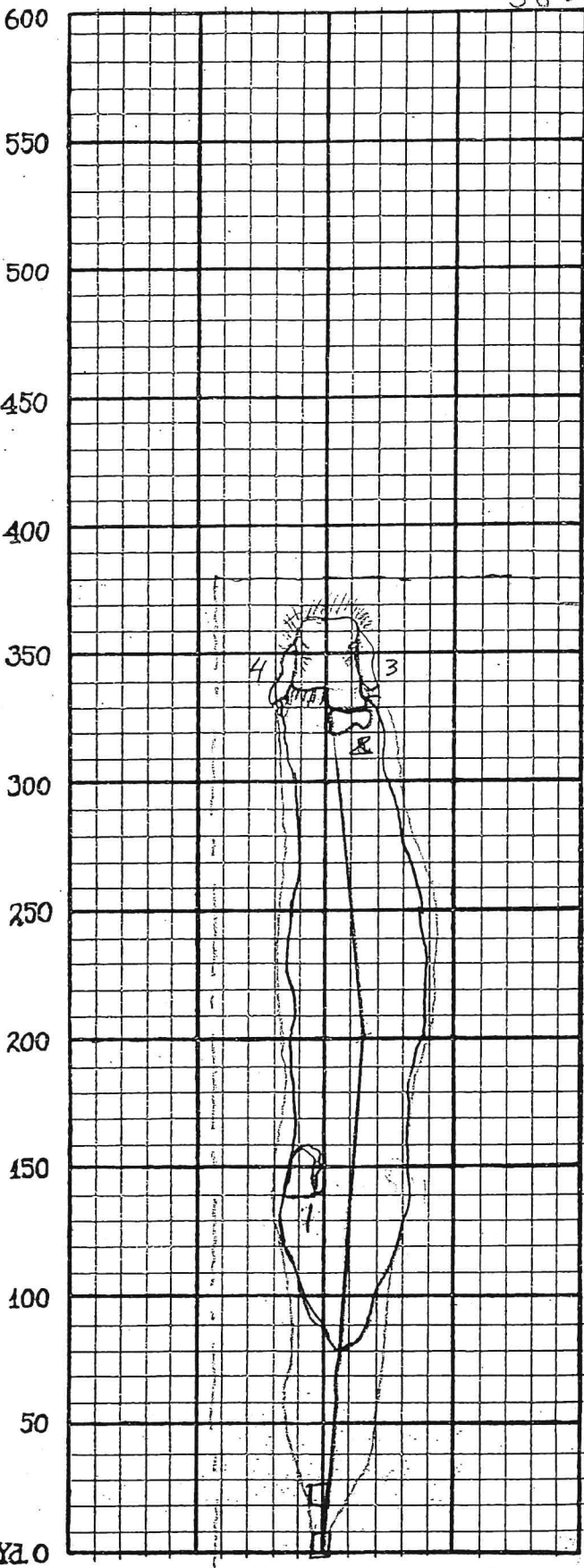

SECTIONS

6	_____
5	_____
4	_____
3	_____
2	_____
1	_____
4	_____
3	_____
2	_____
1	_____
0	_____
1	_____
2	_____
3	_____
0	_____
1	_____
2	_____
3	_____

2 tes - 30' x 20 -  
raised 6" & planted  
with Bermuda -

no 1 - Bunkers -  
depress 2' if drainage  
will permit. The finished  
face to be 4'-6" deep  
& planted with wire  
grass

Green to be in a  
 uniaxial formation  
 at A. fill not less than  
 2'-6"  
 at B- fill not less  
 than 5'

Bunker 2 must have  
 a face 3'-6" deep

Bunkers 3 & 4- have  
 faces formed by the  
 fill or green.

The rear must  
 have an irregular and  
 bold outline -

NOTES

COURSE

HOLE

YARDS

GREEN

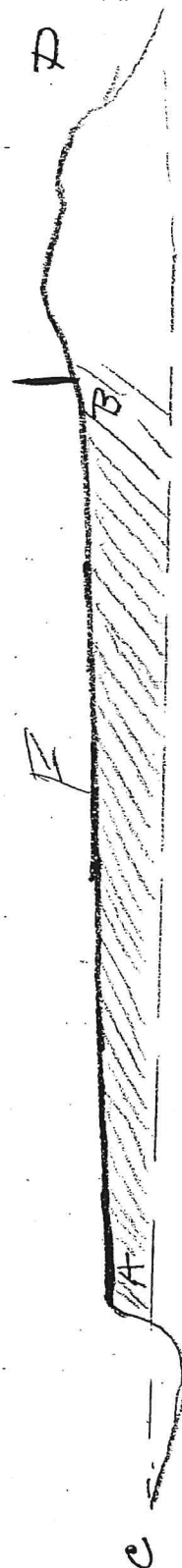
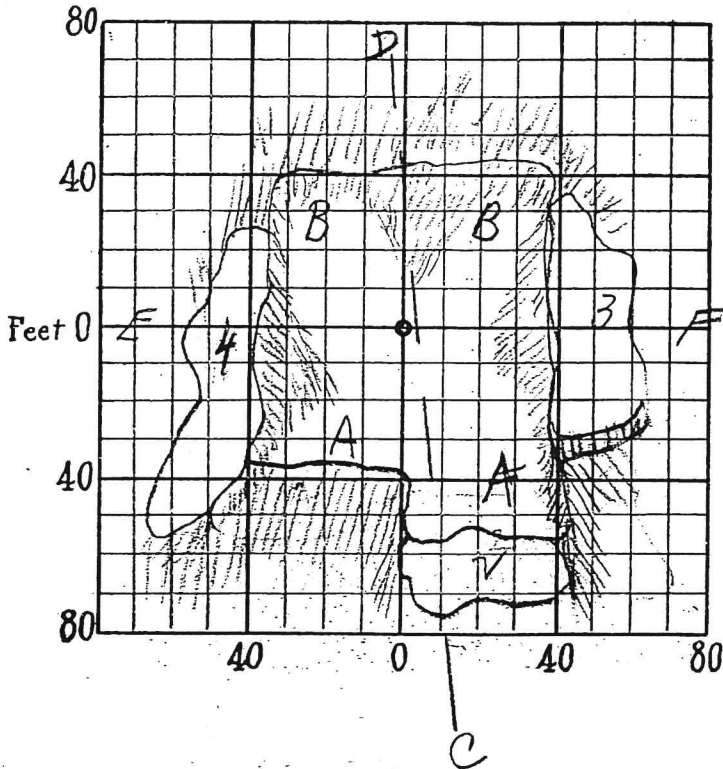



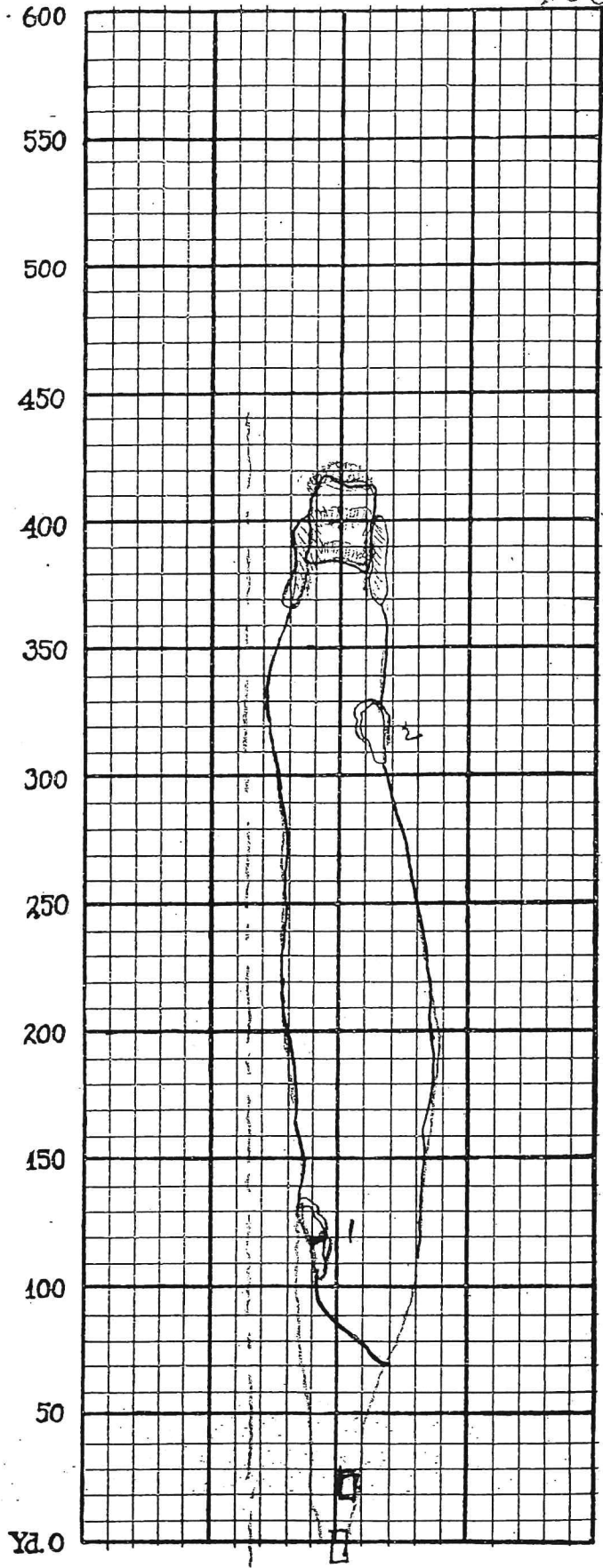

SECTIONS

6
5
4
3
2
1
4
3
2
1
0
1
2
3
2
1
0
1
2
3

2 tiers 40' x 15' raised  
 6" inches + planted with  
 Bermuda grass

No 1 + 2 - Bunkers -  
 depress 2' if drainage  
 will permit - the front  
 face to be not less than  
 4" deep + planted with  
 clumps of wire grass

Raise body of green  
6 inches.

A - an undulation,  
1 1/2' high & 20' wide  
at the base

B - undulation 3' high  
& 30' wide at the base

Platform across centre  
1' above the  
level of the body of green.

C - grass undulation  
not less than 4' high  
& 40' wide at the base

NOTES

COURSE

HOLE

YARDS

GREEN

Make cross sections

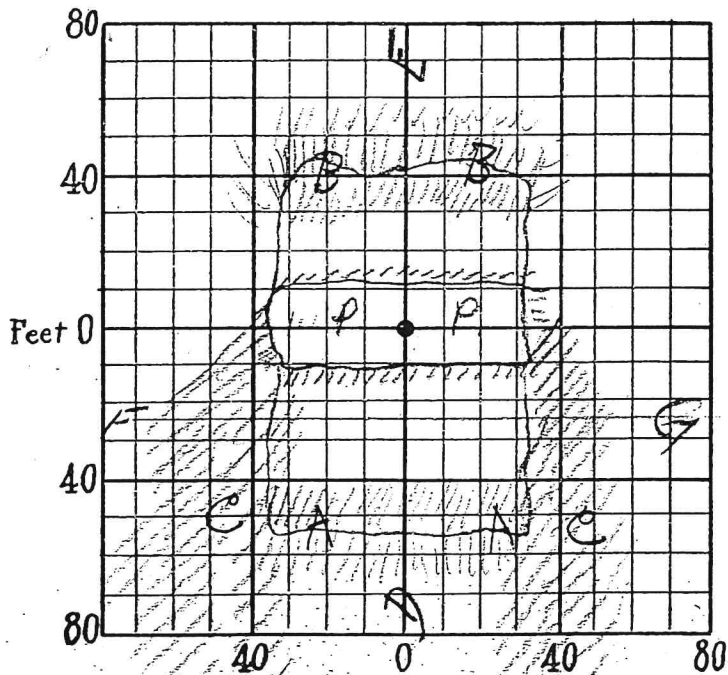

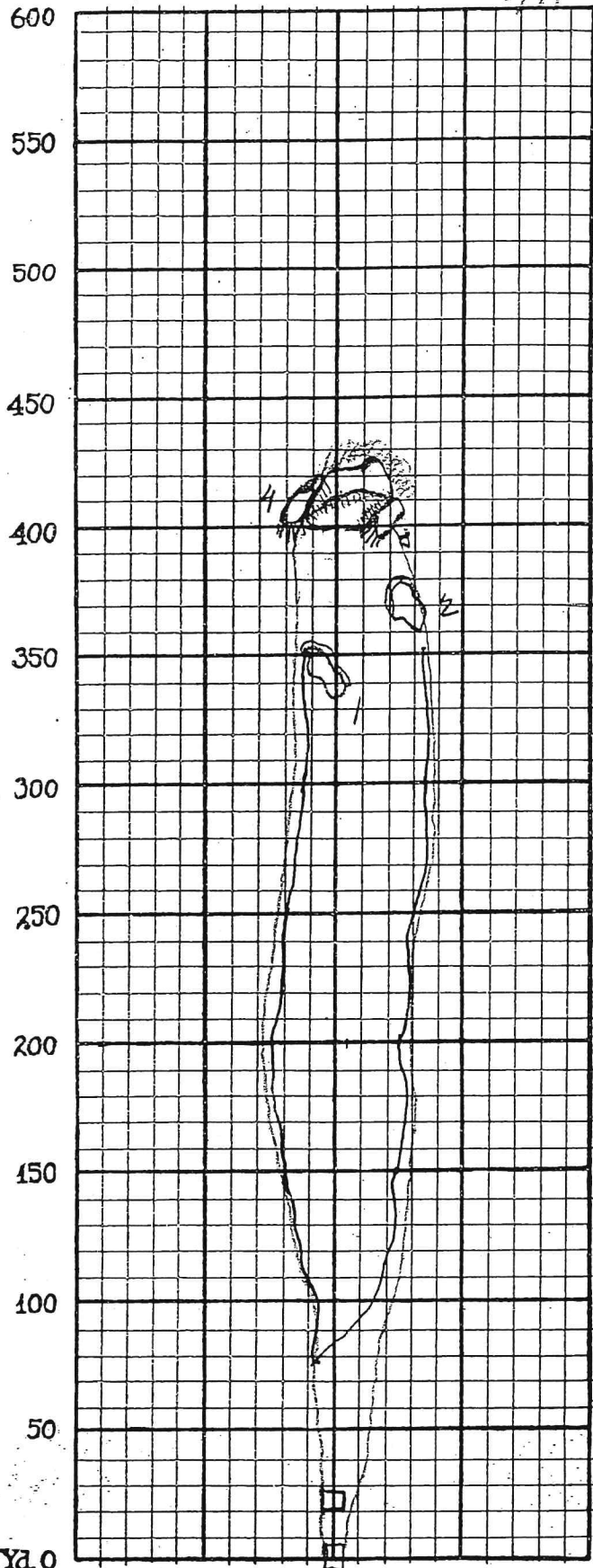

SECTIONS

6	
5	
4	
3	
2	
1	
<hr/>	
4	
3	
2	
1	
0	
1	
2	
<hr/>	
3	
2	
1	
0	
1	
2	
3	

2 lies 20' x 20' raised 6"  
 # planted with Bermuda  
 grass  
 no 1 + 2 Bunkers - depress  
 2' of drainage will form  
 the finished face to be  
 4' deep & planted with tufts  
 of wire grass

Section A. Raised 1'  
Section B: raised 1'-6"  
above A

The back edge at  
C to be irregular  
and raised above  
the level of B -

3, 4. Bunkers finished  
2'-6" to 3'-6" deep.

NOTES

COURSE

HOLE

YARDS

GREEN

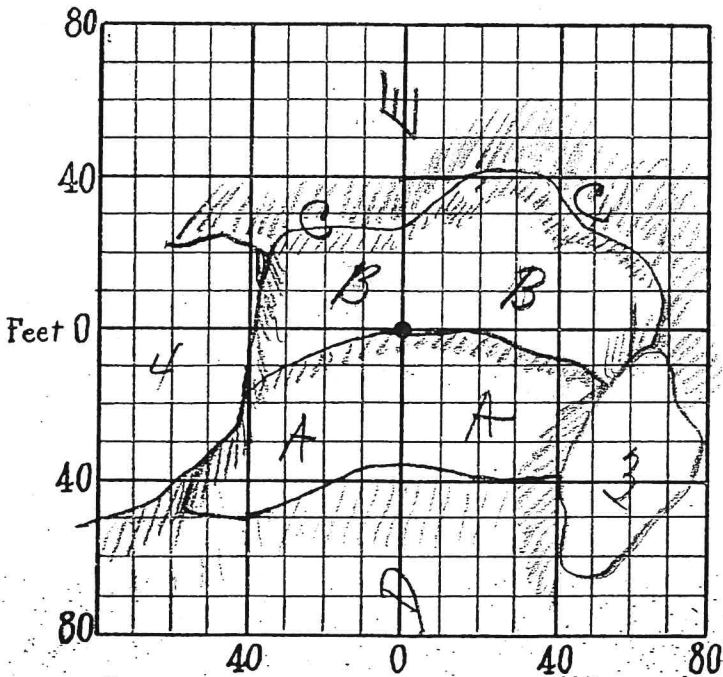

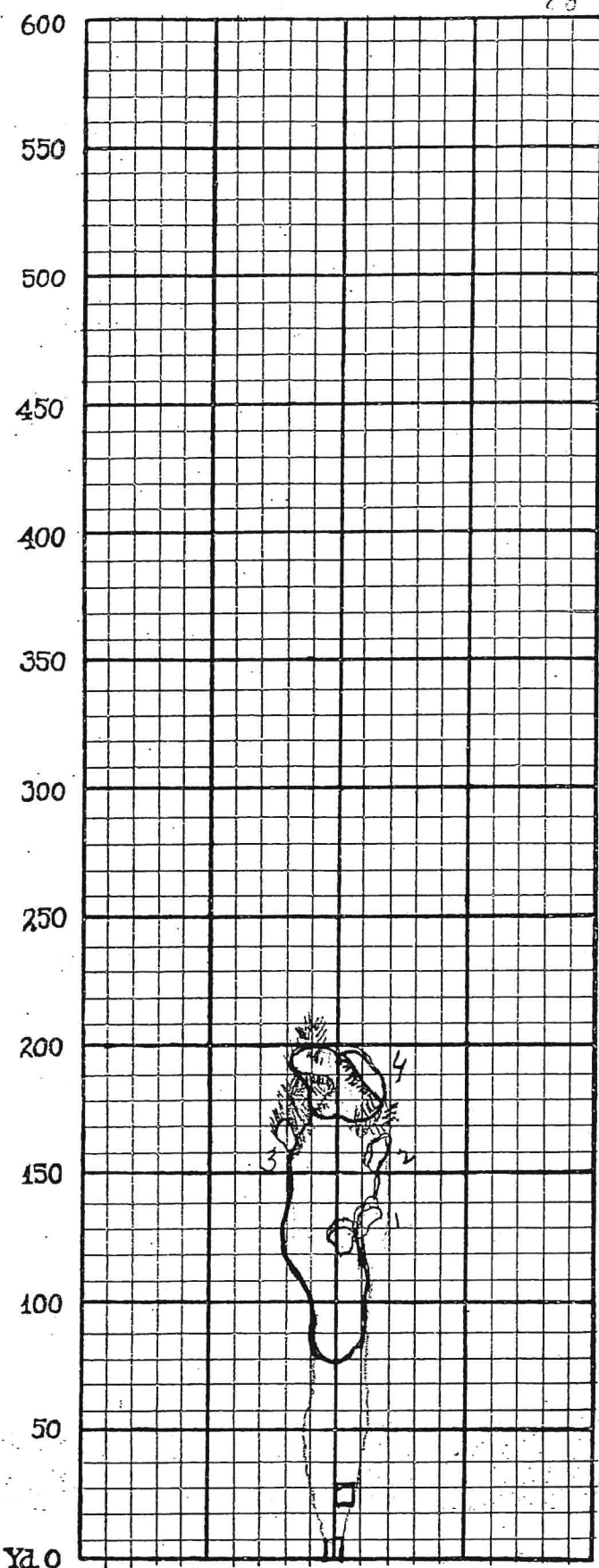

SECTIONS

6	
5	
4	
3	
2	
1	
<hr/>	
4	
3	
2	
1	
0	
1	
2	
<hr/>	
3	
2	
1	
0	
1	
2	
<hr/>	
3	

2 trees 20' + 20' raised  
 6" + planted with  
 Bermuda grass

no 1 + 2 - Bunkers - depress  
 2' if drainage with permit  
 the finished face to be  
 4' deep -

no 3 - Bunker in face  
 of grass mound -

Body of green raised  
at base 1'-6"

undulation A. not  
less than 5' high  
& 40' wide at the  
base -

undulation B - not less  
than 4' high & 30' wide  
at the base

undulation C - not less  
than 4' high & 30' wide  
at the base

NOTES

No 4. Bunker-face to  
be 3' deep.

HOLE

YARDS

all mounds should form  
one rolling GREEN surface - no  
sharp hollows or ridges

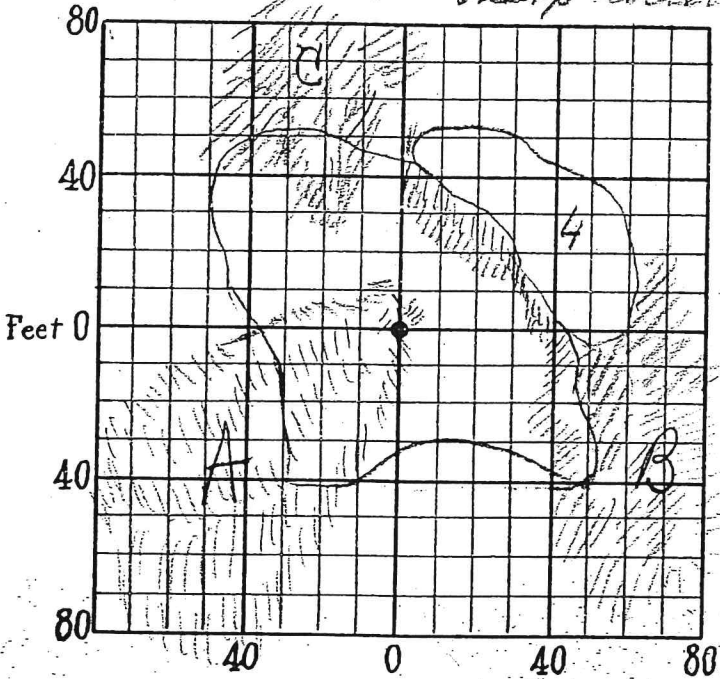

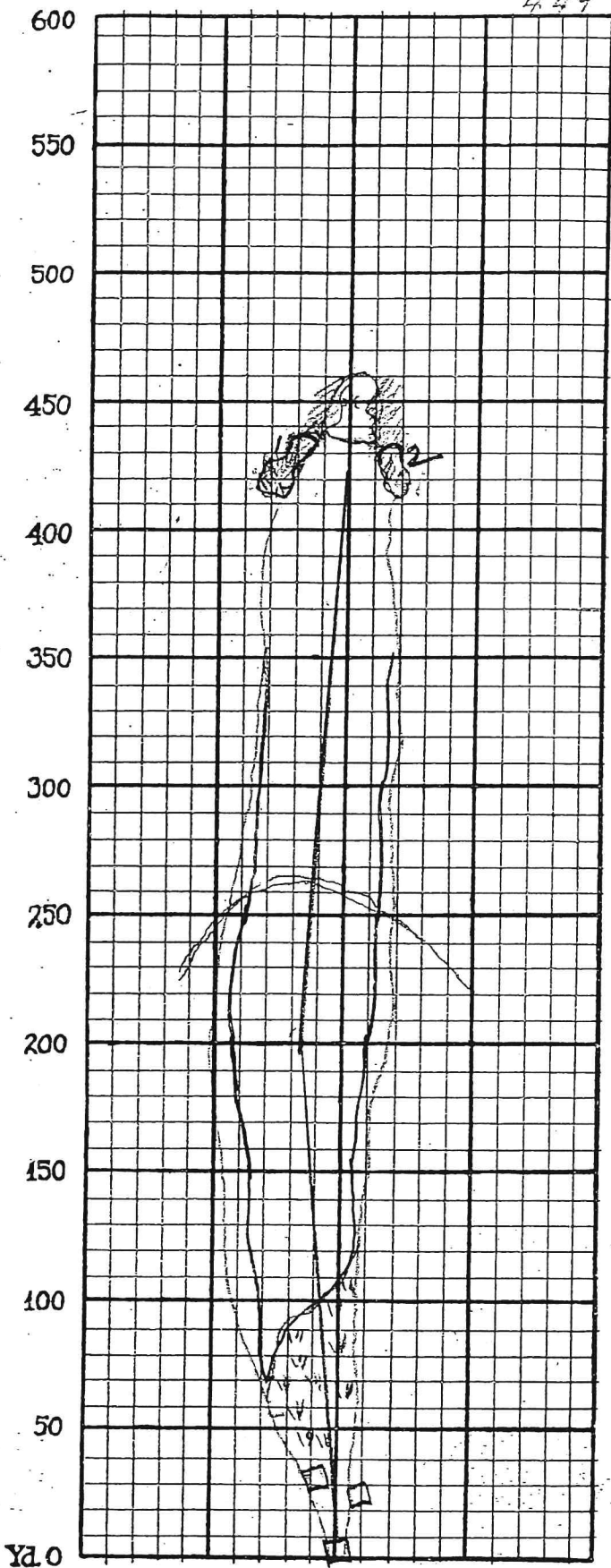

SECTIONS

6
5
4
3
2
1
4
3
2
1
0
1
2
3
2
1
0
1
2
3

3 trees 20' square  
raised 6" + planted with  
Bermuda grass

The ditch treated in the  
same manner as advised  
for no 4 hole -

No 1 & 2 rough mounds  
planted with tufts of wire  
grass - each mound not  
less than 5' high - trees  
opening to green between  
mounds should be 40 yds  
wide - these mound  
stop 5 yds short of green

Body of green raised  
 1'-6" at C and  
 3'-6" at D  
 Mounds A + B - are  
 irregular in shape  
 not less than 3' above  
 level of green - with  
 long easy grades into  
 putting surface forming  
 a slight valley -

NOTES

..... COURSE  
 ..... HOLE ..... YARDS  
 GREEN

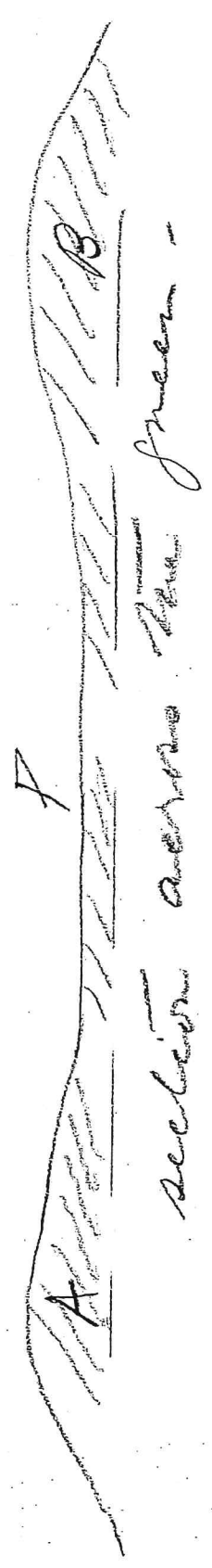
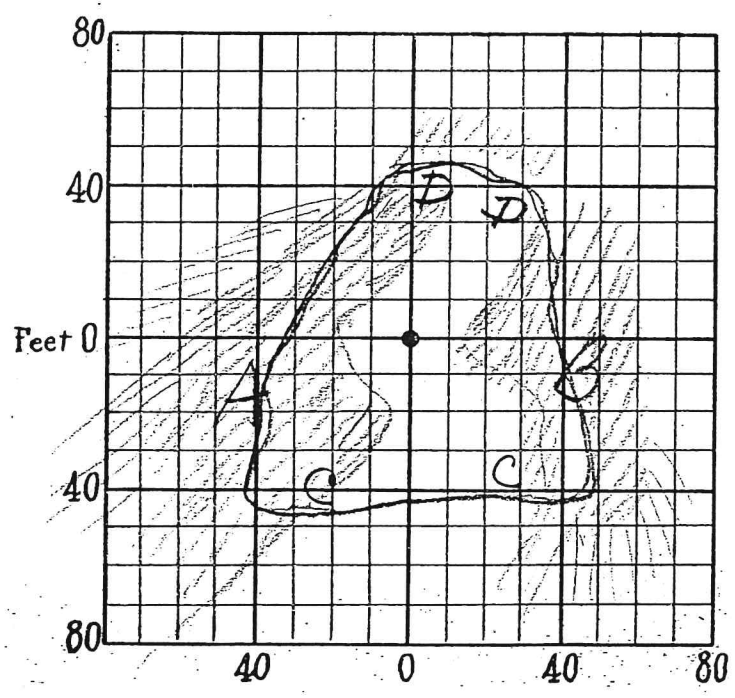



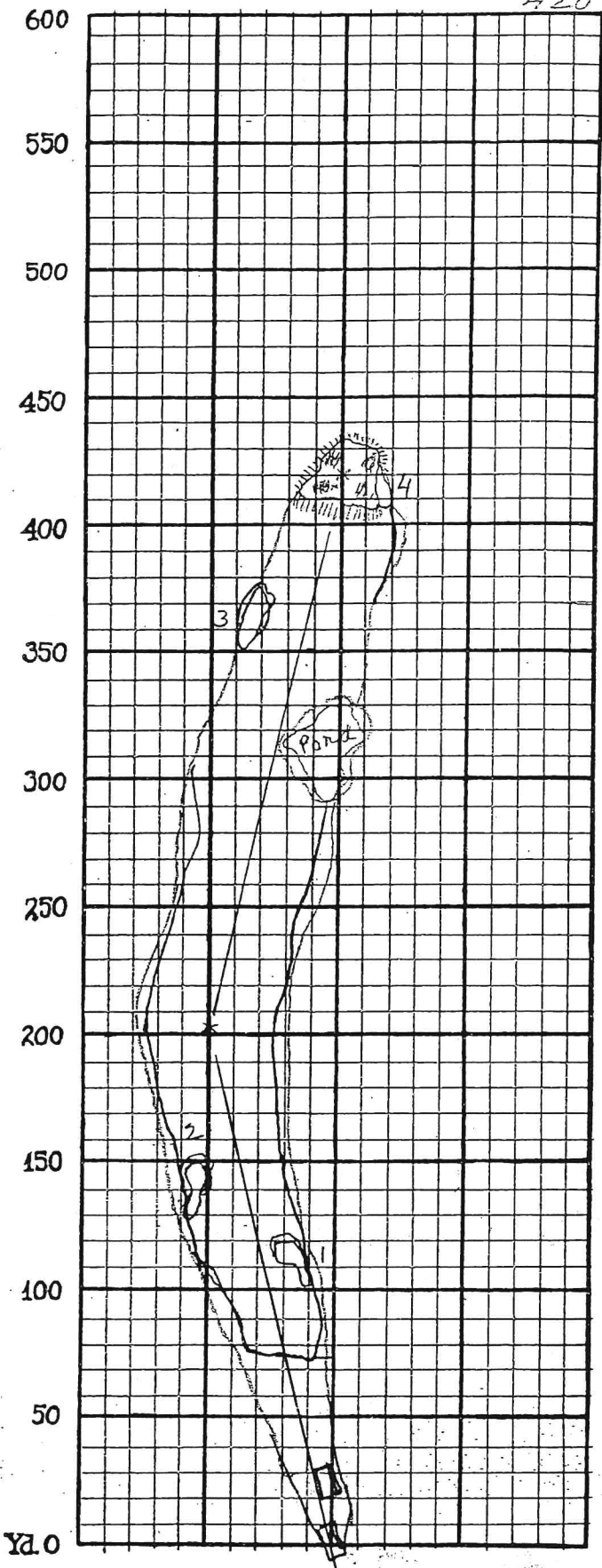

SECTIONS

6	
5	
4	
3	
2	
1	
<hr/>	
4	
3	
2	
1	
0	
1	
2	
<hr/>	
3	
2	
1	
0	
1	
2	
3	

2' x 5' + 15' raised 6"  
 + planted with Bermuda  
 grass  
 nos. 1-2-3 - Breakers  
 depress 2' w/ drainage  
 will permit the finished  
 face to be 4-6" deep

a terraced green  
 at A. raise 3. with  
 a sharp grade on approach  
 at B raise 4. with a  
 sharp grade on finish

Note the four undulations (M)  
 about 9 in high + with  
 easy grades to meet  
 the putting surface

Bunker no 4 - to be  
 finished 3' deep with  
 a steep face

NOTES

COURSE

HOLE

YARDS

GREEN

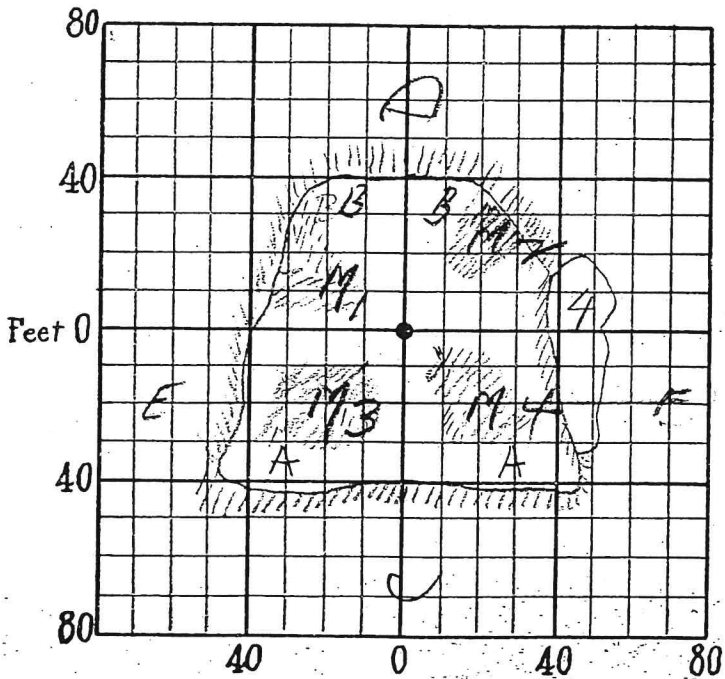

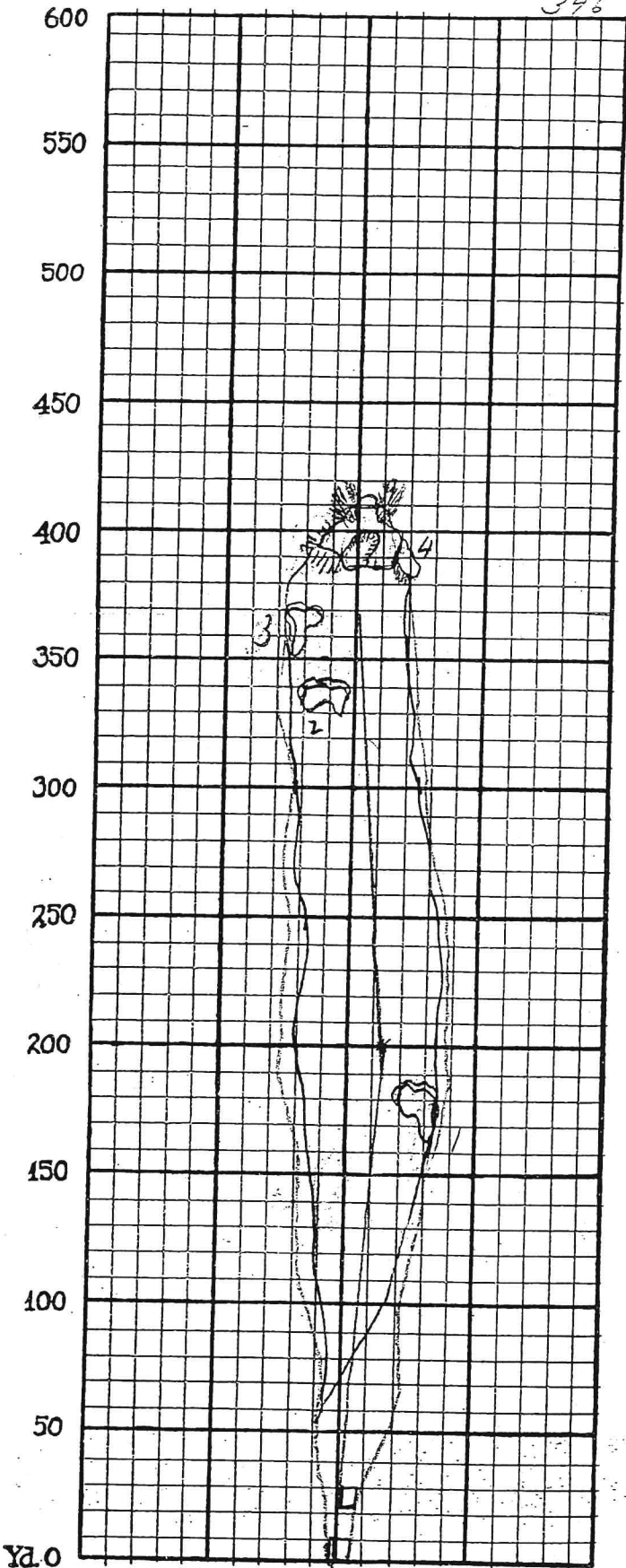

SECTIONS

6	
5	
4	
3	
2	
1	
<hr/>	
4	
3	
2	
1	
0	
1	
2	
3	
2	
1	
0	
1	
2	
3	

2 tees 40' x 15' raised 6"  
 & planted with Bermuda  
 grass

no's - 1 - 2 - 3 - Bunkers  
 depress 2' of drainage  
 will remain, the finished  
 face to be 4' 6" deep  
 & planted with tufts  
 of wire grass -

A. is a hollow - 6" above  
present level

B. is filled 1'-6" above

A.

C. is a continuation of  
B. slightly higher.

D. grass mounds  
not less than 5' high  
blending with easy  
grades into putting surface  
& fair green.

Bunker no 4 - finished  
3'-6" deep

NOTES

COURSE

HOLE

YARDS

GREEN

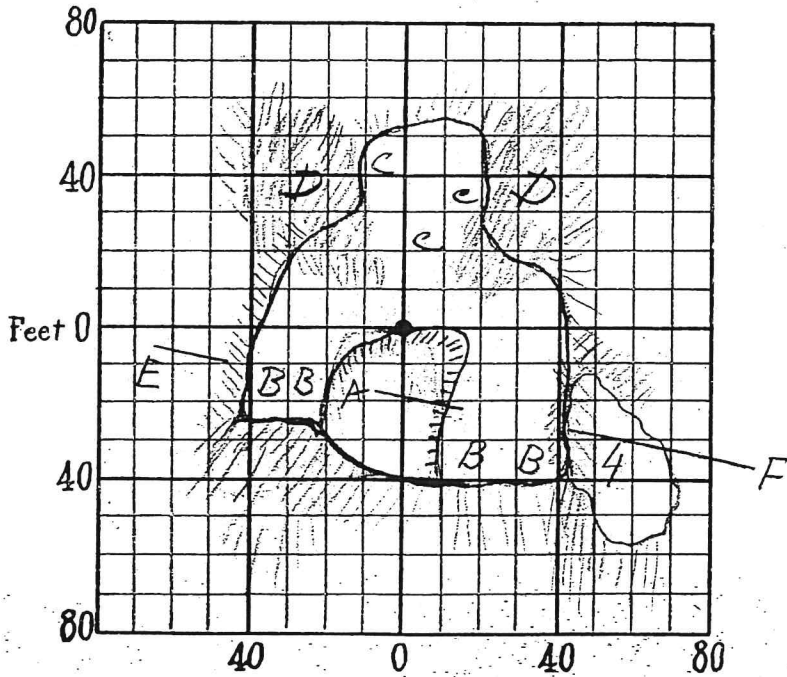

//  
|